

PSG Straight Plug, Key(G), Cable Collet

- Connector series: PSG
- Contact: Male
- Locking type: Self-locking
- Orientation type: Straight
- Part No.: PSG.XT.XXX.CLACXX
- Mated with: FSG series

Note: "X" refers to part number definition on page 70

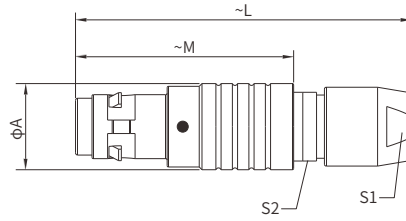

General Information

Ambient temperature:	-55°C ~ + 200°C
Endurance:	>3000 cycles
Insulator:	PEEK
Connector contacts:	Brass with gold plated
Housing:	Brass with Cr plated

Seal/O-ring:	Silicone
Insulation resistance:	$\geq 100M\Omega$
IP rating:	IP68
Shielding efficiency:	at 10MHz>75dB/at 1GHz>40dB
Salt spray corrosion test:	>144h

Size	Dimensions(mm)				
	A	L	M	S1	S1
TT	7.0	33.2	25.2	5.0	5.5
0T	9.5	39.0	29.0	7.0	7.5
1T	12.0	46.0	35.0	9.0	11
2T	15.0	55.0	43.0	12.0	14
3T	18.8	64.0	49.0	14.0	16

FSG Fixed Socket, Nut Fixing, Key(G)

- Connector series: FSG
- Contact: Female
- Locking type: Self-locking
- Orientation type: Straight
- Part No.: FSG.XT.XXX.CLL
- Mated with: PSG series

Note: "X" refers to part number definition on page 70

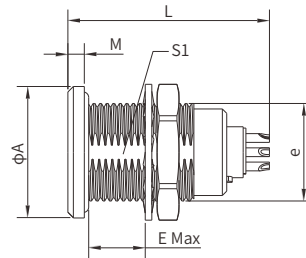

General Information

Ambient temperature:	-55°C ~ + 200°C
Endurance:	>3000 cycles
Insulator:	PEEK
Connector contacts:	Brass with gold plated
Housing:	Brass with Cr plated

Seal/O-ring:	Silicone
Insulation resistance:	$\geq 100M\Omega$
IP rating:	IP68
Shielding efficiency:	at 10MHz>75dB/at 1GHz>40dB
Salt spray corrosion test:	>144h

Size	Dimensions(mm)					
	A	e	E	L	M	S1
TT	10.0	M7*0.5	5.5	16.0	1.2	6.3
0T	12.0	M9*0.6	6.0	21.0	1.5	8.2
1T	15.5	M12*1.0	6.0	23.0	1.8	10.5
2T	18.5	M15*1.0	7.5	26.5	1.8	13.5
3T	23.5	M18*1.0	9.6	30.1	2.5	16.5

Panel cut out(page 164)